

SPECIFICATIONS

MODEL	KM-13F050-275.8-1245	RATED VOLTAGE	DC 12V	SAMPLE NUMBER	
-------	----------------------	---------------	--------	---------------	--

OUTLINE

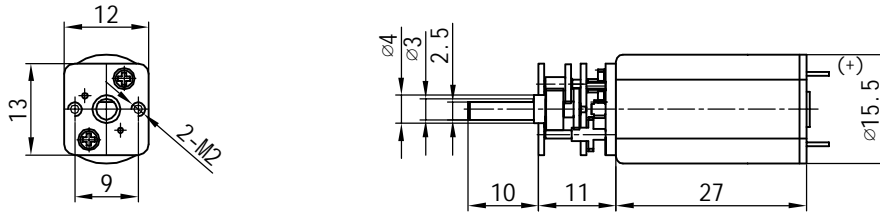

VOLTAGE	NO LOAD		ON LOAD				
	CURRENT	SPEED	CURRENT	SPEED	TORQUE	OUTPUT	EFF
V	A	rpm	A	rpm	Kg. cm	W	%
12	0.033	45.3	0.083	40.7	1	0.41	41.9

REFERENCE CHARACTERISTICS

- 1 DIRECTION OF ROTATION: ANTI-CLOCKWISE WHEN VIEWING MOTOR OUTPUT SIDE WITH POSITIVE VOLTAGE APPLIED TO POSITIVE TERMINAL
- 2 NO LOAD: CURRENT: $\leq 0.05A$
- 3 NO LOAD: SPEED: 45 RPM $\pm 10\%$
- 4 MOTOR END PLAY: ≤ 0.4 MM
- 5 OPERATING TEMPERATURE RANGE: $-10^{\circ}C \sim +60^{\circ}C$
- 6 OPERATING HUMIDITY RANGE: 20 %-90%
- 7 GO WITH MOTOR RANGE: FF-050SH-09230 050 12V 12500rpm/min

CUSTOMER APPROVAL:

PREPARED BY		APPROVED BY		DATE	
-------------	--	-------------	--	------	--