

UE04L3-SPCC

USB Switching Power Charger

4 Watt



• Technical data

Input voltage	100-240V AC
Input current	150mA
Frequency	50-60Hz
Output voltage tolerance	±5%
Low standby power	0.3W Max.

• Environmental specification

Operation temp.	0°C to 40°C at maximum load
Storage temp.	-20°C to 60°C
Humidity	5% to 95% non condensing

• Safety specification

Safety approval	CCC (GB4943) TLC (YD/T1591-2006)
-----------------	-------------------------------------

• Reliability specification

MTBF calculation	50,000 hours at maximum load levels and an ambient temperature of 25°C (in correspondence with MIL-HDBK-217)
------------------	--

• Mechanical specification

Weight	43g
Dimensions	59.0mm x 25.0mm x 36.0mm (2.3" x 1.0" x 1.42")

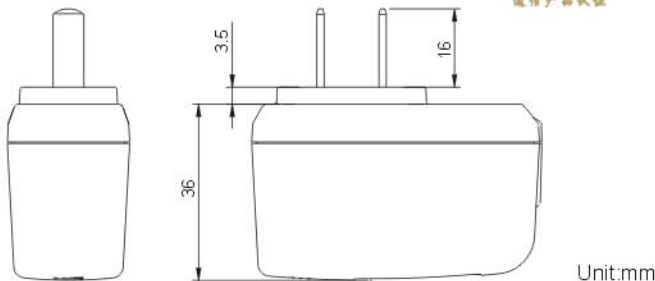

Unit:mm

CCC Output Data

Model	Voltage (V)	Current (A)	Ripple (mV)
UE04L3-050YYYSPCC	5.0	0.05-0.80	200

YYY: 005-080 stands for current: 0.05A-0.80A

TLC Output Data

Model	Voltage (V)	Current (A)	Ripple (mV)
UE04L3-050050SPCC	5.0	500	200
UE04L3-050055SPCC	5.0	550	200
UE04L3-050060SPCC	5.0	600	200
UE04L3-050065SPCC	5.0	650	200
UE04L3-050068SPCC	5.0	680	200
UE04L3-050070SPCC	5.0	700	200
UE04L3-050075SPCC	5.0	750	200
UE04L3-050080SPCC	5.0	800	200

Outline1: Nameplate on the bottom, No LED

Outline2: Nameplate on the bottom, LED

Outline3: Nameplate on the top, No LED

Outline4: Nameplate on the top, LED

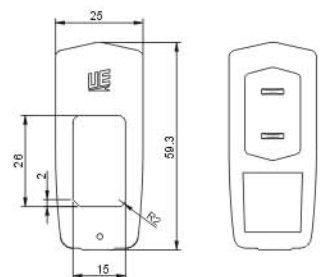
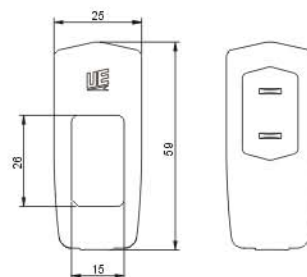
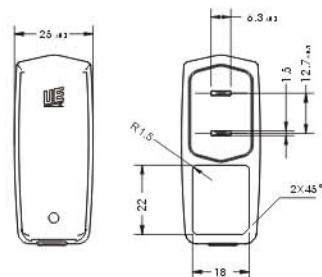
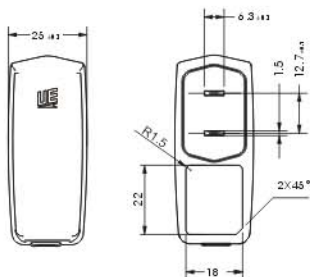

UE Electronic

東莞市石龍富華電子有限公司

中國廣東省東莞市石龍鎮新城區黃洲祥龍路富華電子工業園

Fuhua Electronic Industrial Park, Xianglong Road, Huangzhou, New Town District,
Shilong Town, Dongguan, Guangdong Province, China. 523326
Tel: (86) 769 86022222 Fax: (86) 769 86023333
www.fuhua-cn.com E-mail: fuhua@fuhua-cn.com

Fuhua Electronic (HK) Co., Ltd.

香港九龍彌敦道27-33號良士大廈9樓H室

Flat H, 9/F., Alpha House, 27-33 Nathan Road,
Kowloon, Hong Kong.
Tel: (852) 27391666 Fax: (852) 27395999
www.fuhua.com.hk E-mail: fuhua@fuhua.com.hk