

FA50 Series

- Feature:
- Outline dimensions: 5.3×5.0×1.6 mm
 - Taped products (1000pcs/reel)
 - Lead-free (product contains no lead)

■ Outline Dimensions

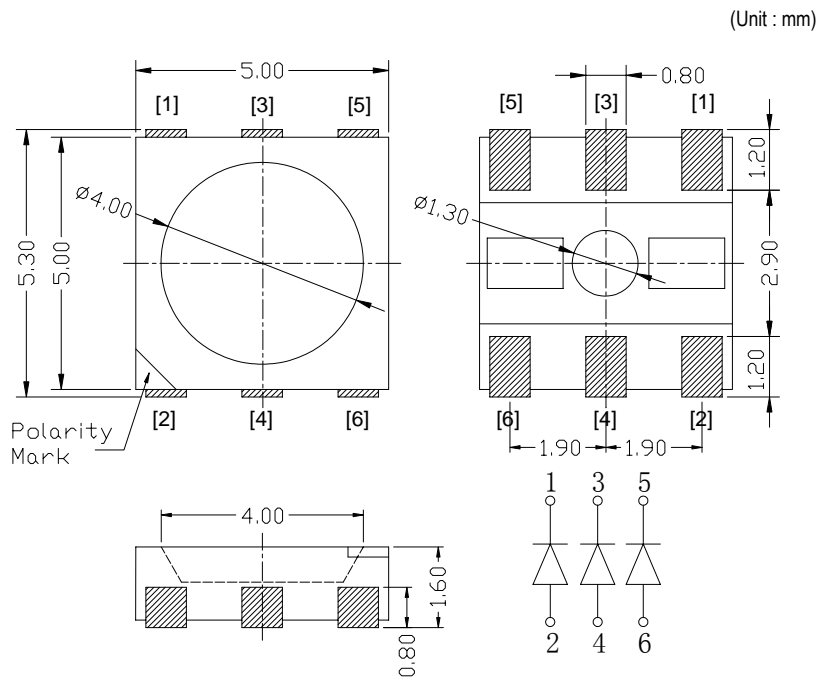

■ Recommended Soldering Pattern For Reflow Soldering

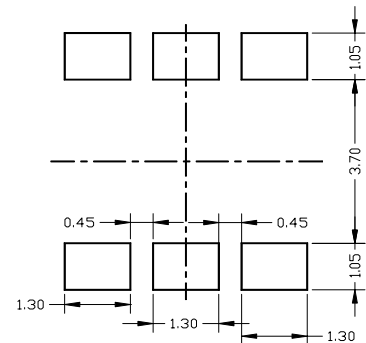

■ Recommended Reflow Soldering Profile

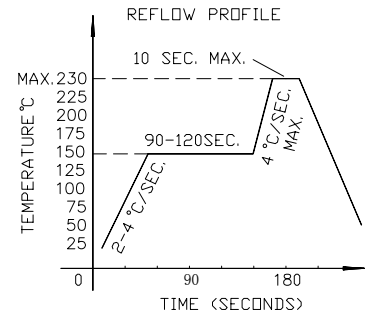

■ Absolute Maximum Ratings

Operation Temperature (Topr)	Storage Temperature (Tstg)	Soldering Temperature (Tsol)
-20~+85°C	-30~+100°C	230°C

■ Electro-optical Characteristics

(Ta=25°C)

Part Number	Emitting color	Viewing angle (2θ _{1/2})	Material	Current	Resin Type	Dominant Wavelength (20mA/pcs)(nm)		Luminous Intensity (20mA/pcs)(mcd)		Forward Voltage (20mA) (v)		Reverse current (μA)	
						Min	Max	Typ	Max	Typ	Max	I _R (max)	V _R
RF-WTFA50DS	White	120	InGaN	20mA	Diffused			3000	4000	3.2	3.8	10	5