

AC Induction Motors

87mm (29 frame size)

98mm (33 frame size)



• **General Specification for AC motors (Under Normal Ambient Temperatures and Humidity)**

- Temperature Rise : 75°C Max
- Ambient Temperature : - 10°C ~ + 40°C
- Insulation Resistance : 100 MΩ Min., 500 VDC
- Dielectric Strength : 1500 VAC for one minute

• **Product Number Code for AC motors**

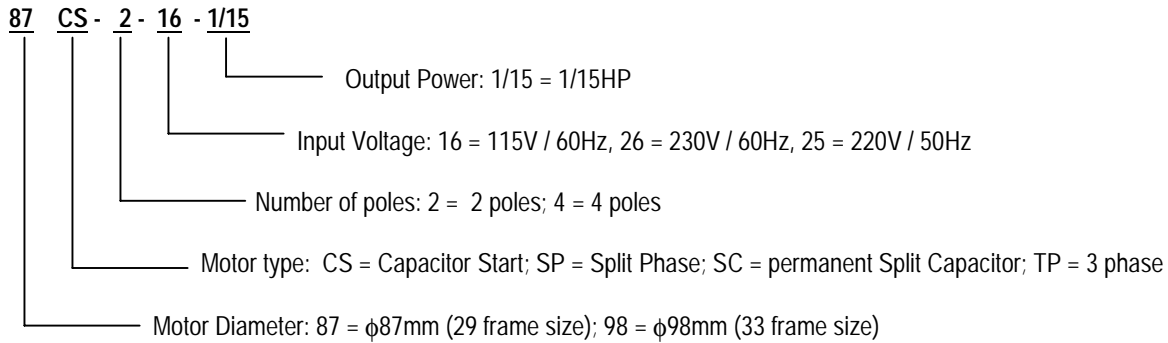

• **Standard Connections**

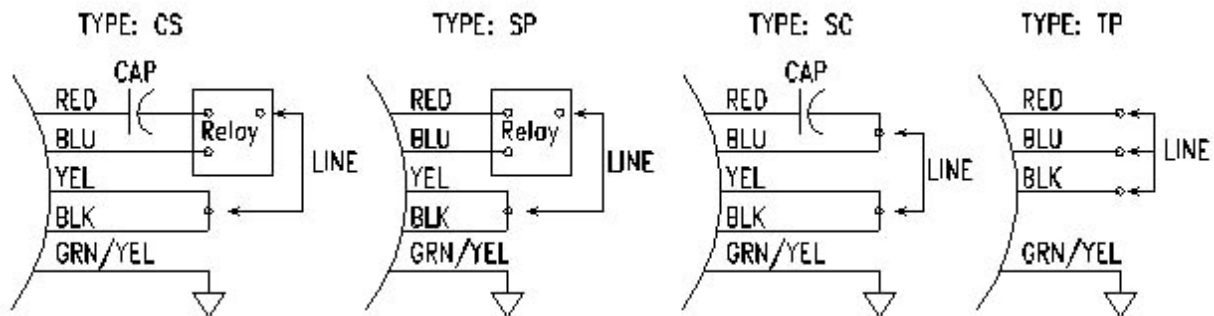

• **Available Options for AC motors**

- Insulation : Class B or Class F with UL approvable
- Protection : Automatic or manual thermal protection
- Motor Modifications : Custom Motor, Custom Windings, Special Bearings
- Shaft Modifications : Double shaft, Flat, Pinion, Keyway, Length
- Lead Wire Modifications : Wire Type, Wire Color, Wire Length, Connector Installation
- Accessories : Relay, Capacitor (where necessary)

87mm Diameter AC Induction Motors (1/60 ~ 1/3 HP)

These $\phi 87$ mm diameter (29 frame size) AC Induction motors are designed for continuous duty at nominal speed of 1650 or 3450 rpm. The output power ranges from 1/60 HP to 1/4 HP for continuous duty applications (consult with factory for intermittent duty). Sealed ball bearings are used for these motors. These motors are class B insulated and can be recognized by UL. Automatic or manual reset thermal protection is available. A wide choice of mounting arrangements and shaft configurations are offered. Four different motor types are available: Permanent split capacitor type (SC), Split phase type (SP), Capacitor start type (CS), and Three-phase type (TP).

Mechanical Dimensions:

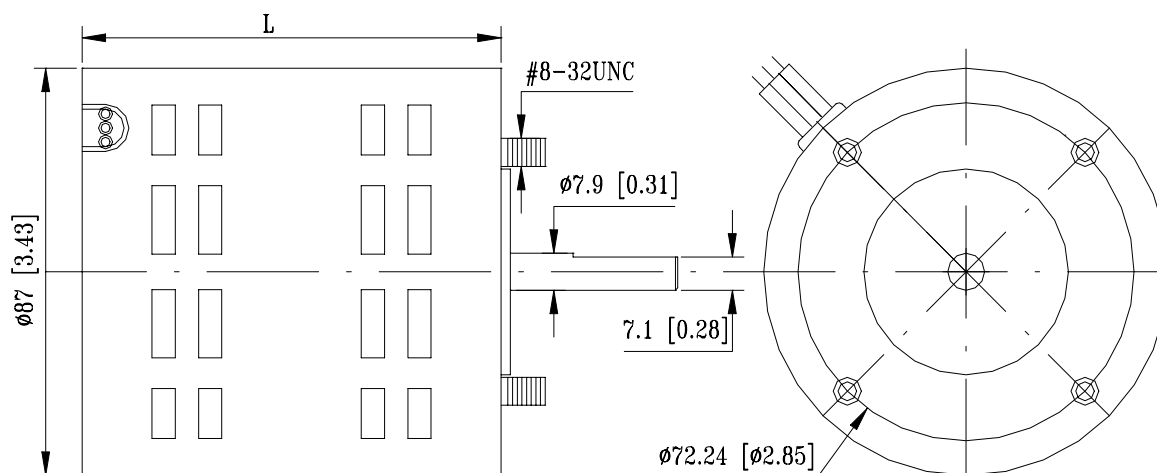

4 Stud Face Mount

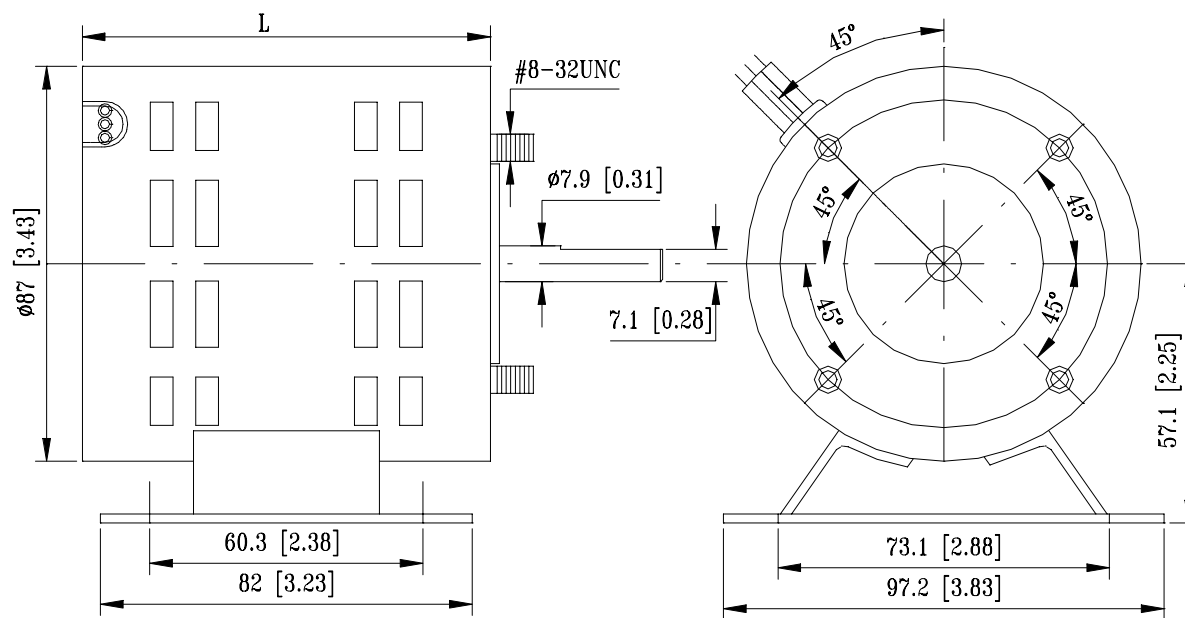

4 Stud Face Mount with Rigid Base

• **Specifications of 87mm diameter AC motors (continuous working mode)**

Model Number	Rated							Max. Oz-in	Starting		Capacitor Mfd/Vac
	Type	Poles	Volts/Hz	Amps	HP	Rpm	Oz-in		Amps	Oz-in	
87CS-2-16-1/15	CS	2	115 / 60	1.7	1/15	3450	20.0	49	5.0	40	36 / 110
87CS-2-16-1/12	CS	2	115 / 60	1.8	1/12	3445	25.0	61	5.6	49	43 / 110
87CS-2-16-1/8	CS	2	115 / 60	2.3	1/8	3460	37.0	101	8.6	74	53 / 110
87CS-2-16-1/6	CS	2	115 / 60	2.8	1/6	3490	50.0	127	11.0	98	53 / 110
87CS-2-16-1/5	CS	2	115 / 60	3.0	1/5	3465	60.0	141	11.7	117	75 / 110
87CS-2-16-1/4	CS	2	115 / 60	3.6	1/4	3460	74.0	168	13.7	126	75 / 110
87SP-2-16-1/15	SP	2	115 / 60	1.7	1/15	3450	20.0	49	10.0	24	
87SP-2-16-1/12	SP	2	115 / 60	1.8	1/12	3445	25.0	61	12.0	31	
87SP-2-16-1/8	SP	2	115 / 60	2.3	1/8	3460	37.0	101	17.0	53	
87SP-2-16-1/6	SP	2	115 / 60	2.8	1/6	3490	50.0	127	19.0	61	
87SP-2-16-1/5	SP	2	115 / 60	3.0	1/5	3465	60.0	141	22.0	73	
87SP-2-16-1/4	SP	2	115 / 60	3.6	1/4	3460	74.0	168	25.0	85	
87SC-2-16-1/15	SC	2	115 / 60	1.0	1/15	3440	20	35	2.2	12	6.0 / 330
87SC-2-16-1/12	SC	2	115 / 60	1.3	1/12	3430	29	56	3.5	17	7.5 / 330
87SC-2-16-1/8	SC	2	115 / 60	1.8	1/8	3445	37	75	5.2	18	7.5 / 330
87SC-2-16-1/6	SC	2	115 / 60	1.9	1/6	3450	49	104	6.5	29	10.0 / 330
87SC-2-16-1/5	SC	2	115 / 60	2.1	1/5	3435	60	115	7.2	30	15.0 / 330
87SC-2-16-1/4	SC	2	115 / 60	2.3	1/4	3420	74	147	9.0	36	15.0 / 330
87TP-2-26-1/10	TP	2	230 / 60	0.4	1/10	3420	29	110	2.2	116	
87TP-2-26-1/8	TP	2	230 / 60	0.5	1/8	3420	37	146	2.9	160	
87TP-2-26-1/6	TP	2	230 / 60	0.6	1/6	3420	49	191	3.8	200	
87TP-2-26-1/5	TP	2	230 / 60	0.8	1/5	3420	59	258	4.9	290	
87TP-2-26-1/4	TP	2	230 / 60	0.9	1/4	3420	74	314	5.9	356	
87TP-2-26-1/3	TP	2	230 / 60	1.3	1/3	3420	98	416	8.0	475	
87CS-4-16-1/60	CS	4	115 / 60	1.1	1/60	1660	10	27	1.8	20	36 / 110
87CS-4-16-1/40	CS	4	115 / 60	1.4	1/40	1670	15	40	2.4	33	36 / 110
87CS-4-16-1/30	CS	4	115 / 60	1.4	1/30	1680	20	52	2.7	42	36 / 110
87CS-4-16-1/25	CS	4	115 / 60	1.5	1/25	1680	24	59	3.0	52	36 / 110
87CS-4-16-1/20	CS	4	115 / 60	1.8	1/20	1685	31	76	3.6	66	43 / 110
87CS-4-16-1/12	CS	4	115 / 60	2.1	1/12	1675	51	98	4.7	108	43 / 110
87SP-4-16-1/60	SP	4	115 / 60	1.1	1/60	1660	10	27	2.6	12	
87SP-4-16-1/40	SP	4	115 / 60	1.4	1/40	1670	15	40	3.5	19	
87SP-4-16-1/30	SP	4	115 / 60	1.4	1/30	1680	20	52	3.9	26	
87SP-4-16-1/25	SP	4	115 / 60	1.5	1/25	1680	24	59	4.5	30	
87SP-4-16-1/20	SP	4	115 / 60	1.8	1/20	1685	31	76	5.6	44	
87SP-4-16-1/12	SP	4	115 / 60	2.1	1/12	1675	51	98	6.6	60	
87SC-4-16-1/25	SC	4	115 / 60	0.9	1/25	1630	24	40	1.5	26	4.0 / 330
87SC-4-16-1/20	SC	4	115 / 60	1.0	1/20	1670	29	72	2.3	32	6.0 / 330
87SC-4-16-1/15	SC	4	115 / 60	1.3	1/15	1680	39	79	2.7	32	7.5 / 330
87SC-4-16-1/12	SC	4	115 / 60	1.3	1/12	1675	49	100	3.1	44	10.0 / 330
87SC-4-16-1/10	SC	4	115 / 60	1.3	1/10	1650	60	121	3.1	61	12.0 / 330
87SC-4-16-1/8	SC	4	115 / 60	1.4	1/8	1655	76	156	3.9	71	15.0 / 330
87TP-4-26-1/25	TP	4	230 / 60	0.5	1/25	1710	23.5	164	1.5	190	
87TP-4-26-1/20	TP	4	230 / 60	0.6	1/20	1710	30.0	197	1.8	227	
87TP-4-26-1/15	TP	4	230 / 60	0.8	1/15	1710	39.0	272	2.4	312	
87TP-4-26-1/12	TP	4	230 / 60	0.9	1/12	1705	49.0	322	2.8	368	
87TP-4-26-1/10	TP	4	230 / 60	0.9	1/10	1705	59.0	347	3.1	395	
87TP-4-26-1/8	TP	4	230 / 60	1.1	1/8	1700	73.0	445	3.8	510	

• **Specifications of 87mm diameter AC motors (continuous working mode)**

Model Number	Rated							Max. Oz-in	Starting		Capacitor Mfd/Vac
	Type	Poles	Volts/Hz	Amps	HP	Rpm	Oz-in		Amps	Oz-in	
87CS-2-25-1/15	CS	2	220 / 50	1.5	1/15	2795	24.0	42	3.6	42	36 / 120
87CS-2-25-1/12	CS	2	220 / 50	1.5	1/12	2790	24.030.0	50	4.0	42	36 / 120
87CS-2-25-1/8	CS	2	220 / 50	2.0	1/8	2800	44.4	76	6.0	70	36 / 120
87CS-2-25-1/6	CS	2	220 / 50	2.5	1/6	2795	60.0	103	7.6	87	43 / 120
87CS-2-25-1/5	CS	2	220 / 50	2.7	1/5	2750	72.0	106	8.0	105	47 / 120
87CS-2-25-1/4	CS	2	220 / 50	3.2	1/4	2755	87.6	134	9.6	122	53 / 120
87SP-2-25-1/15	SP	2	220 / 50	1.5	1/15	2795	24.0	42	59.3	27	
87SP-2-25-1/12	SP	2	220 / 50	1.5	1/12	2790	24.030.0	50	11.6	35	
87SP-2-25-1/8	SP	2	220 / 50	2.0	1/8	2800	44.4	76	16.0	60	
87SP-2-25-1/6	SP	2	220 / 50	2.5	1/6	2795	60.0	103	17.4	70	
87SP-2-25-1/5	SP	2	220 / 50	2.7	1/5	2750	72.0	106	20.0	86	
87SP-2-25-1/4	SP	2	220 / 50	3.2	1/4	2755	87.6	134	22.0	95	
87SC-2-25-1/15	SC	2	220 / 50	0.8	1/15	2765	23.8	38	1.8	16	9.0 / 250
87SC-2-25-1/12	SC	2	220 / 50	1.2	1/12	2765	35.2	56	2.8	20	9.0 / 250
87SC-2-25-1/8	SC	2	220 / 50	1.5	1/8	2810	43.8	80	4.1	26	10.0 / 250
87SC-2-25-1/6	SC	2	220 / 50	1.8	1/6	2800	58.8	106	5.2	35	15.0 / 250
87SC-2-25-1/5	SC	2	220 / 50	2.2	1/5	2805	70.8	140	6.9	40	17.5 / 250
87SC-2-25-1/4	SC	2	220 / 50	2.4	1/4	2790	90.0	154	7.3	47	20.0 / 250
87TP-2-25-1/10	TP	2	220 / 50	0.6	1/10	2850	35	155	2.5	175	
87TP-2-25-1/8	TP	2	220 / 50	0.7	1/8	2850	44	195	3.2	222	
87TP-2-25-1/6	TP	2	220 / 50	0.9	1/6	2850	58	275	4.3	322	
87TP-2-25-1/5	TP	2	220 / 50	1.0	1/5	2850	71	337	5.2	396	
87TP-2-25-1/4	TP	2	220 / 50	1.2	1/4	2850	88	421	6.5	498	
87TP-2-25-1/3	TP	2	220 / 50	2.0	1/3	2850	119	622	9.4	740	
87CS-4-25-1/60	CS	4	220 / 50	0.7	1/60	1300	12	18	1.7	35	36 / 120
87CS-4-25-1/40	CS	4	220 / 50	1.0	1/40	1310	18	29	2.2	52	36 / 120
87CS-4-25-1/30	CS	4	220 / 50	1.2	1/30	1330	24	40	2.7	62	36 / 120
87CS-4-25-1/25	CS	4	220 / 50	1.2	1/25	1330	29	47	2.7	69	36 / 120
87CS-4-25-1/20	CS	4	220 / 50	1.7	1/20	1340	37	65	3.4	83	36 / 120
87CS-4-25-1/12	CS	4	220 / 50	1.7	1/12	1260	61	73	3.4	101	36 / 120
87SP-4-25-1/60	SP	4	220 / 50	0.7	1/60	1300	12	18	2.1	15	
87SP-4-25-1/40	SP	4	220 / 50	1.0	1/40	1310	18	29	3.0	23	
87SP-4-25-1/30	SP	4	220 / 50	1.2	1/30	1330	24	40	3.6	31	
87SP-4-25-1/25	SP	4	220 / 50	1.2	1/25	1330	29	47	4.2	41	
87SP-4-25-1/20	SP	4	220 / 50	1.7	1/20	1340	37	65	5.3	54	
87SP-4-25-1/12	SP	4	220 / 50	1.7	1/12	1260	61	73	5.6	57	
87SC-4-25-1/25	SC	4	220 / 50	0.5	1/25	1220	28	36	0.8	24	6.0 / 220
87SC-4-25-1/20	SC	4	220 / 50	0.6	1/20	1325	35	59	1.2	36	8.0 / 220
87SC-4-25-1/15	SC	4	220 / 50	0.8	1/15	1315	47	76	1.6	42	10.0 / 220
87SC-4-25-1/12	SC	4	220 / 50	1.0	1/12	1310	59	93	1.9	52	12.0 / 220
87SC-4-25-1/10	SC	4	220 / 50	1.1	1/10	1330	72	122	2.5	68	12.5 / 220
87SC-4-25-1/8	SC	4	220 / 50	1.5	1/8	1290	105	151	3.1	79	15.0 / 220
87TP-4-25-1/25	TP	4	220 / 50	0.6	1/25	1425	28	182	1.5	211	
87TP-4-25-1/20	TP	4	220 / 50	0.7	1/20	1425	35	225	1.8	261	
87TP-4-25-1/15	TP	4	220 / 50	1.0	1/15	1425	47	318	2.5	369	
87TP-4-25-1/12	TP	4	220 / 50	1.2	1/12	1425	59	397	3.1	463	
87TP-4-25-1/10	TP	4	220 / 50	1.2	1/10	1425	70	493	3.6	577	
87TP-4-25-1/8	TP	4	220 / 50	1.8	1/8	1425	88	627	3.7	739	

98mm Diameter AC Induction Motors (1/50 ~ 1/3 HP)

These $\phi 98$ mm (33 frame size) AC Induction motors are designed for continuous duty at nominal speed of 1650 or 3450 rpm. The output power ranges from 1/50HP to 1/3HP for continuous duty applications (consult with factory for intermittent duty). Sealed ball bearings are used for these motors. These motors are class B insulated and can be recognized by UL or CE. Automatic or manual reset thermal protection is available. A wide choice of mounting arrangements and shaft configurations are offered. Four different motor types are available: Permanent split capacitor type (SC), Split phase type (SP), Capacitor start type (CS), and Three-phase type (TP).

Mechanical Dimensions:

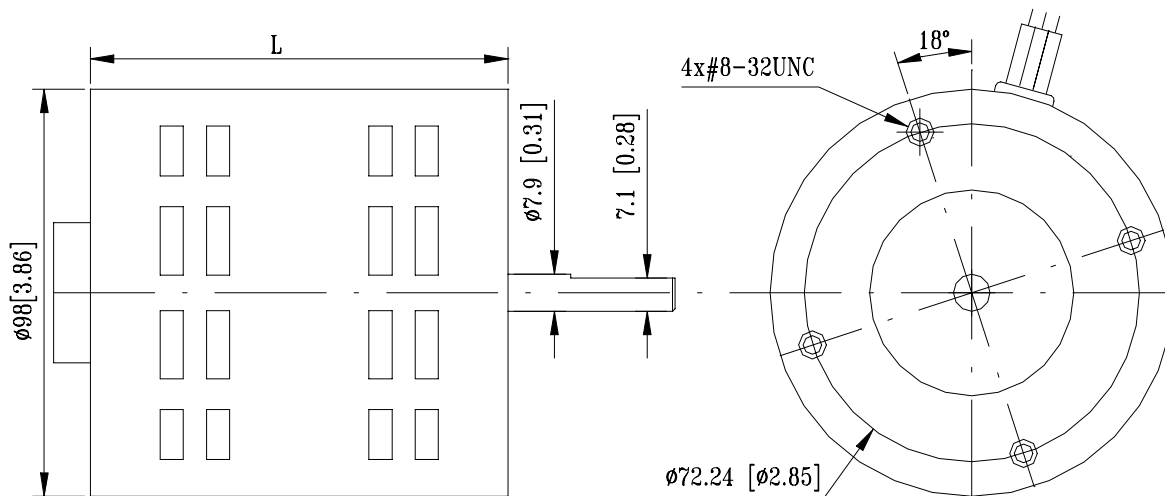

4 Boss Face Mount

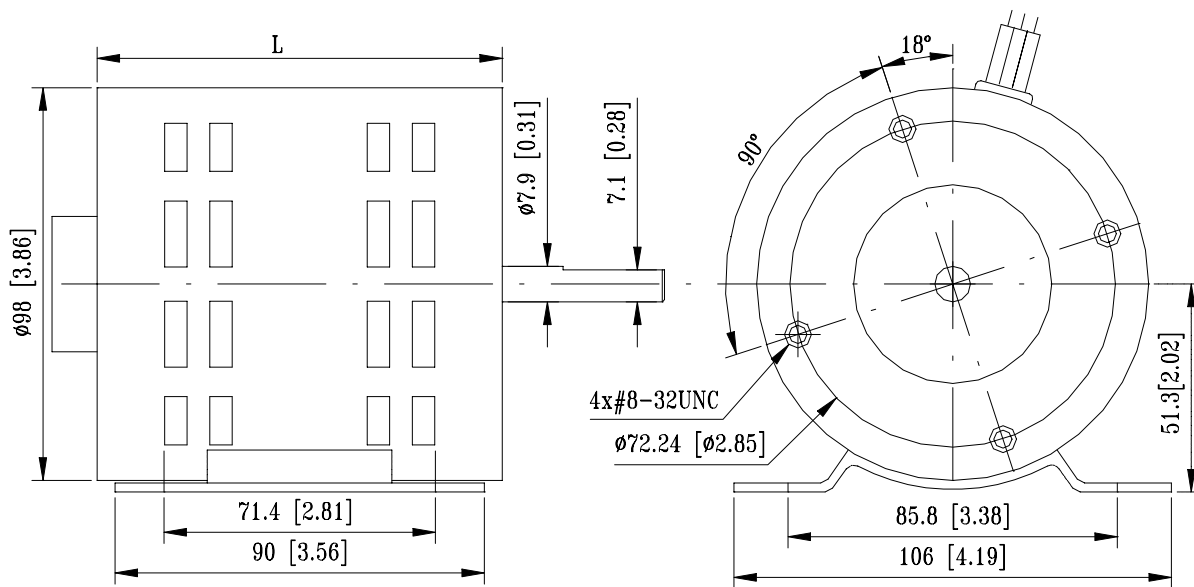

4 Boss Face Mount with Rigid Base

• **Specifications of 98mm Diameter AC motors (continuous working mode)**

Model Number	Rated							Max. Oz-in	Starting		Capacitor Mfd/Vac
	Type	Poles	Volts/Hz	Amps	HP	Rpm	Oz-in		Amps	Oz-in	
98CS-2-16-1/12	CS	2	115 / 60	1.3	1/12	3450	25	53	7.9	67	145 / 110
98CS-2-16-1/10	CS	2	115 / 60	1.5	1/10	3450	29	63	9.1	85	161 / 110
98CS-2-16-1/8	CS	2	115 / 60	1.6	1/8	3450	37	73	10.5	102	189 / 110
98CS-2-16-1/6	CS	2	115 / 60	2.1	1/6	3450	49	102	13.3	132	216 / 110
98CS-2-16-1/4	CS	2	115 / 60	3.1	1/4	3450	74	155	17.8	196	270 / 110
98CS-2-16-1/3	CS	2	115 / 60	4.0	1/3	3450	99	202	24.8	278	400 / 110
98SP-2-16-1/12	SP	2	115 / 60	1.3	1/12	3450	25	53	12.7	36	
98SP-2-16-1/10	SP	2	115 / 60	1.5	1/10	3450	29	63	16.4	47	
98SP-2-16-1/8	SP	2	115 / 60	1.6	1/8	3450	37	73	17.1	53	
98SP-2-16-1/6	SP	2	115 / 60	2.1	1/6	3450	49	102	23.8	67	
98SP-2-16-1/4	SP	2	115 / 60	3.1	1/4	3450	74	155	33.5	109	
98SP-2-16-1/3	SP	2	115 / 60	4.0	1/3	3450	99	202	47.4	147	
98SC-2-16-1/12	SC	2	115 / 60	0.9	1/12	3490	25	50	3.1	10	12.0 / 330
98SC-2-16-1/10	SC	2	115 / 60	1.0	1/10	3490	29	63	3.9	11	12.0 / 330
98SC-2-16-1/8	SC	2	115 / 60	1.2	1/8	3485	37	79	5.1	10	12.0 / 330
98SC-2-16-1/6	SC	2	115 / 60	1.6	1/6	3480	49	96	6.4	13	15.0 / 330
98SC-2-16-1/4	SC	2	115 / 60	2.3	1/4	3490	74	163	10.6	19	20.0 / 330
98SC-2-16-1/3	SC	2	115 / 60	3.2	1/3	3480	99	197	13.3	22	25.0 / 330
98TP-2-26-1/12	TP	2	230 / 60	0.3	1/12	3420	25	79	1.7	71	
98TP-2-26-1/10	TP	2	230 / 60	0.4	1/10	3420	29	88	1.9	79	
98TP-2-26-1/8	TP	2	230 / 60	0.4	1/8	3420	37	116	2.4	107	
98TP-2-26-1/6	TP	2	230 / 60	0.5	1/6	3420	49	160	3.2	150	
98TP-2-26-1/4	TP	2	230 / 60	0.7	1/4	3420	74	247	5.0	240	
98TP-2-26-1/3	TP	2	230 / 60	1.0	1/3	3420	98	292	6.1	282	
98CS-4-16-1/20	CS	4	115 / 60	1.1	1/20	1710	30	68	5.1	82	75 / 110
98CS-4-16-1/15	CS	4	115 / 60	1.5	1/15	1710	39	97	5.9	111	88 / 110
98CS-4-16-1/12	CS	4	115 / 60	1.7	1/12	1710	49	109	8.4	133	108 / 110
98CS-4-16-1/10	CS	4	115 / 60	2.0	1/10	1710	59	138	8.4	164	130 / 110
98CS-4-16-1/8	CS	4	115 / 60	2.6	1/8	1710	74	188	11.0	210	161 / 110
98CS-4-16-1/6	CS	4	115 / 60	3.1	1/6	1710	100	206	12.2	277	161 / 110
98SP-4-16-1/20	SP	4	115 / 60	1.1	1/20	1710	30	68	6.2	42	
98SP-4-16-1/15	SP	4	115 / 60	1.5	1/15	1710	39	97	8.4	60	
98SP-4-16-1/12	SP	4	115 / 60	1.7	1/12	1710	49	109	10	69	
98SP-4-16-1/10	SP	4	115 / 60	2.0	1/10	1710	59	138	12	91	
98SP-4-16-1/8	SP	4	115 / 60	2.6	1/8	1710	74	188	14	107	
98SP-4-16-1/6	SP	4	115 / 60	3.1	1/6	1710	100	206	20	152	
98SC-4-16-1/20	SC	4	115 / 60	0.6	1/20	1730	29	61	1.6	18	9.0 / 330
98SC-4-16-1/15	SC	4	115 / 60	0.8	1/15	1730	39	91	2.5	23	12.0 / 330
98SC-4-16-1/12	SC	4	115 / 60	1.0	1/12	1730	49	119	3.2	30	15 / 330
98SC-4-16-1/10	SC	4	115 / 60	1.1	1/10	1730	59	140	3.9	30	15 / 330
98SC-4-16-1/8	SC	4	115 / 60	1.4	1/8	1730	74	172	4.8	39	20 / 330
98SC-4-16-1/6	SC	4	115 / 60	1.8	1/6	1730	98	230	6.5	49	25 / 330
98TP-4-26-1/20	TP	4	230 / 60	0.3	1/20	1710	29	121	1.2	112	
98TP-4-26-1/15	TP	4	230 / 60	0.3	1/15	1710	39	166	1.6	155	
98TP-4-26-1/12	TP	4	230 / 60	0.4	1/12	1710	49	204	2.1	191	
98TP-4-26-1/10	TP	4	230 / 60	0.4	1/10	1710	59	237	2.3	224	
98TP-4-26-1/8	TP	4	230 / 60	0.6	1/8	1710	74	306	3.1	292	
98TP-4-26-1/6	TP	4	230 / 60	0.7	1/6	1710	98	386	3.7	377	

• **Specifications of 98mm Diameter AC motors (continuous working mode)**

Model Number	Rated							Max. Oz-in	Starting		Capacitor Mfd/Vac
	Type	Poles	Volts/Hz	Amps	HP	Rpm	Oz-in		Amps	Oz-in	
98CS-2-25-1/12	CS	2	220 / 50	0.8	1/12	2870	29	61	3.5	63	36/220
98CS-2-25-1/10	CS	2	220 / 50	0.9	1/10	2870	35	75	4.1	80	43/220
98CS-2-25-1/8	CS	2	220 / 50	1.0	1/8	2870	44	86	4.5	94	47/220
98CS-2-25-1/6	CS	2	220 / 50	1.4	1/6	2870	60	150	5.8	133	53/220
98CS-2-25-1/4	CS	2	220 / 50	1.9	1/4	2870	90	177	7.3	158	64/220
98CS-2-25-1/3	CS	2	220 / 50	2.6	1/3	2870	120	223	10.6	250	108/220
98SP-2-25-1/12	SP	2	220 / 50	0.8	1/12	2870	29	61	6.5	40	
98SP-2-25-1/10	SP	2	220 / 50	0.9	1/10	2870	35	75	8.4	55	
98SP-2-25-1/8	SP	2	220 / 50	1.0	1/8	2870	44	86	9.0	60	
98SP-2-25-1/6	SP	2	220 / 50	1.4	1/6	2870	60	150	12.0	80	
98SP-2-25-1/4	SP	2	220 / 50	1.9	1/4	2870	90	177	17.0	130	
98SP-2-25-1/3	SP	2	220 / 50	2.6	1/3	2870	120	223	24.0	180	
98SC-2-25-1/12	SC	2	220 / 50	0.5	1/12	2890	24	53	1.7	9	3/370
98SC-2-25-1/10	SC	2	220 / 50	0.6	1/10	2890	36	74	2.1	10	3/370
98SC-2-25-1/8	SC	2	220 / 50	0.8	1/8	2890	44	88	2.8	13	4/370
98SC-2-25-1/6	SC	2	220 / 50	1.1	1/6	2890	60	108	3.5	13	4/370
98SC-2-25-1/4	SC	2	220 / 50	1.6	1/4	2890	90	193	6.3	24	5/370
98SC-2-25-1/3	SC	2	220 / 50	2.1	1/3	2890	120	200	5.0	43	10/370
98TP-2-25-1/12	TP	2	220 / 50	0.3	1/12	2850	24	135	1.3	120	
98TP-2-25-1/10	TP	2	220 / 50	0.3	1/10	2850	36	195	1.5	180	
98TP-2-25-1/8	TP	2	220 / 50	0.4	1/8	2850	44	230	1.8	229	
98TP-2-25-1/6	TP	2	220 / 50	0.6	1/6	2850	60	285	2.7	318	
98TP-2-25-1/4	TP	2	220 / 50	0.9	1/4	2850	90	505	4.2	502	
98TP-2-25-1/3	TP	2	220 / 50	1.1	1/3	2850	120	529	5.2	660	
98CS-4-25-1/20	CS	4	220 / 50	0.7	1/20	1420	35	79	2.3	84	21/220
98CS-4-25-1/15	CS	4	220 / 50	1.0	1/15	1420	47	110	2.8	108	21/220
98CS-4-25-1/12	CS	4	220 / 50	1.1	1/12	1415	60	123	3.7	140	30/220
98CS-4-25-1/10	CS	4	220 / 50	1.2	1/10	1415	72	145	4.1	160	30/220
98CS-4-25-1/8	CS	4	220 / 50	1.6	1/8	1410	90	200	4.5	188	43/220
98CS-4-25-1/6	CS	4	220 / 50	1.9	1/6	1410	122	210	5.1	250	43/220
98SP-4-25-1/20	SP	4	220 / 50	0.7	1/20	1420	35	79	3.1	50	
98SP-4-25-1/15	SP	4	220 / 50	1.0	1/15	1420	47	110	4.2	775	
98SP-4-25-1/12	SP	4	220 / 50	1.1	1/12	1415	60	123	5.1	84	
98SP-4-25-1/10	SP	4	220 / 50	1.2	1/10	1415	72	145	6.1	115	
98SP-4-25-1/8	SP	4	220 / 50	1.6	1/8	1410	90	200	6.5	135	
98SP-4-25-1/6	SP	4	220 / 50	1.9	1/6	1410	122	210	9.1	185	
98SC-4-25-1/20	SC	4	220 / 50	0.3	1/20	1440	35	75	0.9	21	2.5/370
98SC-4-25-1/15	SC	4	220 / 50	0.4	1/15	1440	47	96	1.4	24	3.0/370
98SC-4-25-1/12	SC	4	220 / 50	0.6	1/12	1440	59	130	1.8	30	4.0/370
98SC-4-25-1/10	SC	4	220 / 50	0.7	1/10	1430	72	150	2.1	30	4.5/370
98SC-4-25-1/8	SC	4	220 / 50	0.8	1/8	1430	90	175	2.5	36	5.0/370
98SC-4-25-1/6	SC	4	220 / 50	1.2	1/6	1430	120	230	3.4	44	6.0/370
98TP-4-25-1/20	TP	4	220 / 50	0.2	1/20	1410	35	225	0.5	260	
98TP-4-25-1/15	TP	4	220 / 50	0.3	1/15	1410	47	305	0.8	352	
98TP-4-25-1/12	TP	4	220 / 50	0.4	1/12	1410	59	387	1.0	445	
98TP-4-25-1/10	TP	4	220 / 50	0.5	1/10	1410	72	475	1.3	547	
98TP-4-25-1/8	TP	4	220 / 50	0.6	1/8	1410	90	598	1.5	688	
98TP-4-25-1/6	TP	4	220 / 50	0.7	1/6	1410	120	774	1.8	924	

56 Frame Size AC Motors

B56



• **Specifications of 56 frame size AC motors (continuous working mode)**

HP	RPM	# OF POLES	Full Load Current (Amp)		Starting Torque %	Maximum Torque %	Starting Current %
			230V (3PH)	460V (3PH)			
1/2	3400	2	1.6	0.8	250	265	525
	1700	4	1.8	0.91	200	250	450
3/4	3400	2	2.2	1.1	230	260	550
	1700	4	2.7	1.35	220	280	450
1	3400	2	3.1	1.55	280	300	550
	1700	4	4	2	275	325	500
1 1/2	3400	2	4.4	2.2	300	300	560
	1700	4	5.2	2.6	250	280	440
2	3400	2	6	3.1	210	250	450
	1700	4	7.8	4	200	240	450
3	3400	2	8.8	4.3	220	250	540
	1700	4	10.2	5.1	200	240	450