

Pasmiko®

MAINTENANCE-FREE RECHARGEABLE BATTERY

VALVE-REGULATED LEAD-ACID BATTERY(LEAD-CALCIUM)

CP4-2

2V 4AH

Dimensions

CP4-2 (mm)

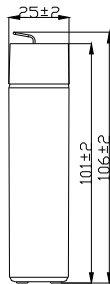
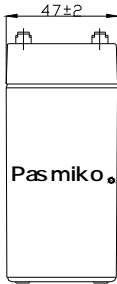
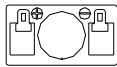

Terminal

(mm)

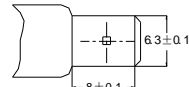
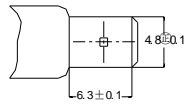

Terminal type:F1

Terminal type:F2

Scale=1:4

SPECIFICATION

Total height	:	106mm(4.17inch)
Container height	:	104mm(3.9inch)
Length	:	47mm(1.85inch)
Width	:	25mm(0.98inch)
Weight	:	approximate 0.30kg
Internal resistance	:	approximate 35mΩ
Container material	:	flame retardant A.B.S

CHARACTERISTIC

Nominal voltage	:	2V
20hour rate(0.2A to 1.75V)	:	4AH
10hour rate(0.38A to 1.75V)	:	3.8AH
5hour rate(0.68A to 1.70V)	:	3.4AH
3hour rate(1A to 1.70V)	:	3AH
1hour rate(2.4A to 1.55V)	:	2.4AH
1C (4A to 1.30V)	:	1.8AH
2C (8A to 1.30V)	:	1.7AH
3C (12A to 1.30V)	:	1.6AH
Max discharge current	:	60A(5eq)

DISCHARGE CAPACITY UNDER DIFFERENT TEMPERATURES

40°C	:	102%
25°C	:	100%
0°C	:	85%

CHARGING Methods at (25°C,77°F)

Standby use	:	2.25V~23V
Cycle use	:	2.4~25V
Max charging current	:	12A

SELF-DISCHARGE RESIDUAL CAPACITY (25°C, 77°F)

After 3 months	:	90%
After 6 months	:	82%
After 12months	:	70%

ENDURANCE in CYCLES

Cycle use	:	
100% depth of discharge	:	225 cycles
50% depth of discharge	:	450 cycles
30% depth of discharge	:	1100 cycles
Standby use	:	3-5 years

