

16MM

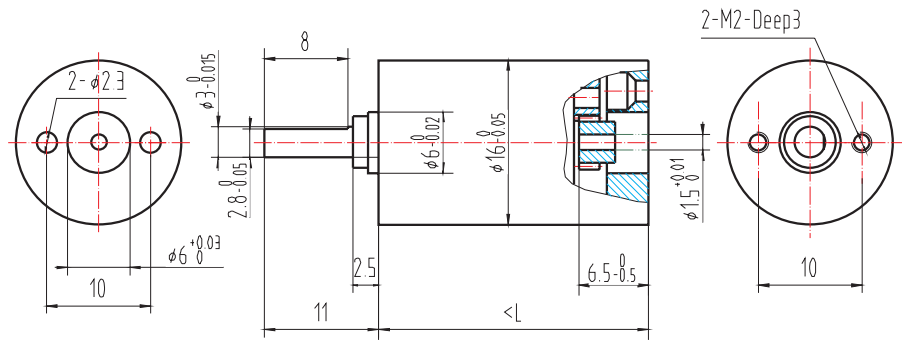

性能规格 Specification							
段数 Stage NO.		L1	L2	L3	L4	L5	L6
减速比范围 Reduction Ratio		3.79,4.31, 5.08	14,16,18,20, 22,26	54,62,70,73, 80,82	94,111,206,267,303,357,407,479,495,564,664	791,889,1012,1151,1310,1402,1543,1755,1879,2067,2517,3372	2961,17123
长度 Length (mm)		14.8	18.4	22	25.6	29.2	32.8
输出扭矩 output torque (N.m)	连续 Continuous	0.2	0.3	0.3	0.3	0.3	0.3
	瞬时 Intermittent	0.3	0.5	0.5	0.5	0.5	0.5
效率 Efficiency (%)		90	81	73	65	59	53
空载回差 No-load Backlash		1°	1.2	1.5	1.8	2	2
重量 Weight (g)		14	18	22	26	30	34
技术参数 Technic Parameter							
壳体材料 Housing material							不锈钢 Stainless steel
齿轮材料 Gear train material							钢 all steel
推荐最大输入转速 Recommended max. input speed for:							6,000 rpm
- 连续运转 continuous operation							
输入输出旋转方向 Direction of rotation(reversible)							=
输出端轴承 Bearings on output shaft							滚动轴承 ball bearing
输出轴负载 Shaft load, max.							
最大允许径向载荷 radial (6 mm from mounting face)							≤ 8N
最大允许轴向载荷 axial Shaft press fit force, max.							≤ 8N
最大允许安装力 Shaft press fit force, max.							≤ 100N
输出轴间隙 Shaft play							
- 径向间隙 radial (5 mm from flange)							≤ 0.06 mm
- 轴向间隙 axial Operating temperature range							≤ 0.1 mm
推荐温度范围 Operating temperature range							-30 to +105 °C

Topband gear box